

Borrower Responsibility & Replacement Costs

- Framingham Public Library Rokus are pre-configured with accounts, channels, and content. Accounts, channels or content on the device must not be modified. Please notify the library if any expected content is missing.
- Borrower should be aware that browsing and viewing history may be seen by subsequent borrowers.
- The library is not responsible for any costs incurred or damage to personal equipment while borrowers use the Roku or for the security of connected patron devices.
- The library does its best to provide clean and fully functional equipment, but is not responsible for unforeseen hardware or software failure.
- Borrowers are responsible for the safe-keeping and return of these items to the library in good working order and assume liability for the equipment while it is in their care.
- Borrower is responsible for damaged and/or missing pieces of the package.



Framingham
PUBLIC LIBRARY

Look here first.

Main Library • 49 Lexington Street • 508-532-5570
Christa McAuliffe Branch Library • 746 Water Street • 508-532-5636
www.framinghamlibrary.org

Setup Instructions continued

Before you return your Roku:

- If you wish to erase your wireless settings on the Roku:
 - Go to the home screen
 - Select:
 - => Settings
 - => System
 - => Advanced System Settings
 - => Network Connection Reset
 - => Reset Connection
- Make sure all of the components are back in the case
- Return the device to staff at the Circulation Desk

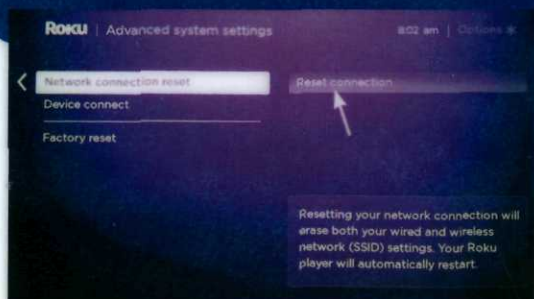

Get to know your Roku



- A MIC Microphone for voice search
- B BACK Return to previous screen
- C HOME Return to Roku home screen
- D UP or DOWN Move up or down; LEFT or RIGHT Move left or right
- E HEADPHONE JACK Plug in headphones here
- F VOLUME +/- Increase/decrease the volume of your headphones
- G VOICE SEARCH Use your voice to search for content
- H OK Select an option from a menu
- I OPTIONS View more options
- J REV SCAN Rewind, scroll left one page at a time
- K PLAY/PAUSE Start or pause playback
- L FWD SCAN Fast forward, scroll right one page at a time
- M CHANNEL SHORTCUT Instant access to favorite channels
- N A & B Action buttons for gaming

Setup Instructions

Note: our Roku works only with TVs that have an HDMI port.

- Connect the supplied HDMI cable from the Roku into an HDMI port on your TV.
- Insert two AA batteries into the Roku remote, if they are not already installed. (the remote control does not need to be aimed at the Roku; it just needs to be in the same room)
- Plug the Roku power adapter into the round jack in the Roku, and then into a power source. It will turn on automatically.
- Turn on your TV, and select the appropriate HDMI input source. You should see the Roku screen.
- Set up your network connection
 - Press the Home button on the remote, scroll down to Settings, and then scroll to the right to Network.
 - If you want to establish a wireless connection, select Wireless and enter your wireless network name (and password, if necessary).
 - If you want to use a wired connection, connect an Ethernet cable (not supplied) between the Roku and your router, and select Wired Connection in Network Settings.



Note: For further information and troubleshooting visit: <https://support.roku.com>

Roku Streaming Media Player

Return to Framingham Public Library

Cannot be returned to other libraries

Roku Circulation Policy

- Loan: 14 days
- No Renewal
- Fines: \$2.00 per day overdue
- Limit: 1 Roku per person
- Must be returned to the Front Desk at the library from which it was borrowed.
- Do not use the outdoor book return.

**RETURN TO
STAFF MEMBER**



**DO NOT USE BOOK
RETURN**

| Roku Equipment | Cost to replace each item |
|----------------------------------|----------------------------------|
| Roku Device | \$90 |
| Roku Remote | \$15 |
| Roku Power Adapter | \$10 |
| Case | \$11 |
| Roku HDMI cable | \$3 |
| Instruction Sheet & Channel List | \$5 |
| Lost box | \$109 |



Framingham
PUBLIC LIBRARY

Look here first.

Main Library • 49 Lexington Street • 508-532-5570

Christa McAuliffe Branch Library • 746 Water Street • 508-532-5636

www.framinghamlibrary.org

To Watch Netflix

The Netflix logo, featuring the word "NETFLIX" in a bold, white, sans-serif font with a black outline, set against a red rectangular background.

- Go to the Netflix Channel
- Use Search to find specific titles or
- Browse lists

**Thank you to the Friends of
the Framingham Library for
the Netflix Subscription.**



**FRIENDS of the
FRAMINGHAM
LIBRARY**

To Watch Vudu



- Go to the Vudu Channel
- Select My Vudu
- Select Movies or TV Shows to watch



**Framingham
PUBLIC LIBRARY**

Look here first.

Main Library • 49 Lexington Street • 508-532-5570
Christa McAuliffe Branch Library • 746 Water Street • 508-532-5636
www.framinghamlibrary.org

Roku Channels

This is the current Roku channel lineup,
not necessarily in any order.

| | | |
|---|---|---|
|  |  |  |
|  |  |  |
|  |  |  |
|  |  |  |
|  |  |  |